



CITUS CRLA20

20 lipsticks/minute filling machine

WHEN QUALITY COUNTS, GO TO THE INVENTOR OF IT

CRLA20 MAIN BENEFITS

Superior quality

- Perfect end results
- Shapes, motifs and logo embossing
- No flaming

Very user-friendly

- Simple setup
- No cleaning between bulks
- Superfast changeovers

Extremely flexible

- Standard jumbo lipstick
- Slim pencil lipstick
- Mini lipstick

Simply reliable

- Simple design, robust materials
- Simple maintenance
- Stable set-up over production

With more than 150 lipstick machines running worldwide, Citus Kalix is recognised as the gold reference for surface effects, including shining, embossing and brilliance.

We invented the silicone technology for lipstick moulding. Since the patent in 1996 it has become the preferred choice for major luxury brands, many of which are 100 per cent equipped by us.

Advanced technology for perfection

Our exclusive silicone technology allows demoulding without friction. This virtually eliminates the risk of damaging the surface and makes embossing not only possible, but flawless as well.

The possibilities to create attractive or branded appearances are unlimited. As masters of mould manufacturing, creating silicone moulds for new lipstick shapes, motifs or logo embossing is a significant part of our activities.

Superior operation

The CRLA20 machine can run at 20 parts per minute with jumbo, slim and mini lipsticks. Besides delivering perfect products, it offers superior operator-friendly use. It is robust, reliable and easy to run. No cleaning from one bulk to another is required and changeovers are superfast, even between different lipstick mechanisms.

Our dedicated team helps you adapt the machines to your specific needs and provides technical support throughout products.

Contact us today!

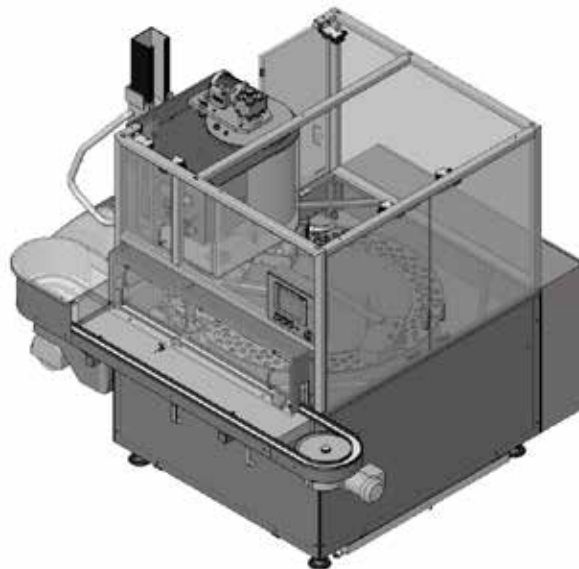

*Maximise productivity
and flexibility with
perfect surface results.*



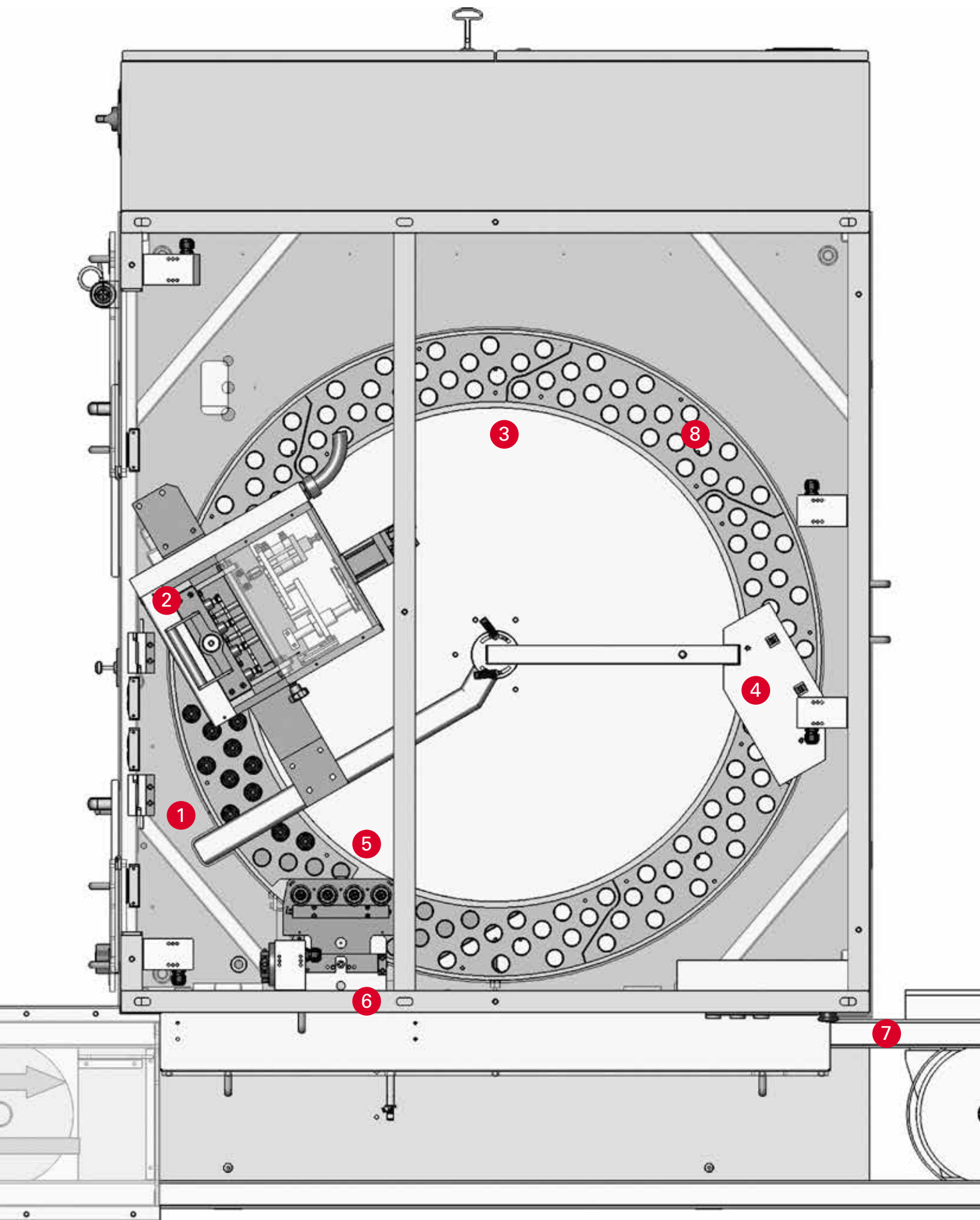

1. Mould pre-heating

Heats the silicone moulds prior to filling.

2. Four pump filler

Servo driven.

3. Cooling

The output of 20 lipsticks per minute is based on a five minutes cooling time.

4. Reheating unit

Remelts the top part of the paste.

5. Opening units

Four opening units enable unmoulding and picking.

6. Manipulator and grippers

Control the gripping plate movement.

7. Conveyor

Transports the pucks.

8. Moulds

140 moulds, covered by the patented process and exclusively produced by Citus Kalix.



LIPSTICK MOULDING PROCESS

Filling

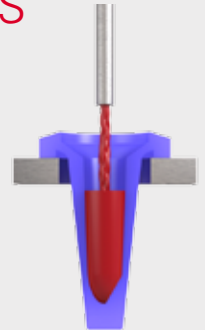

Cooling

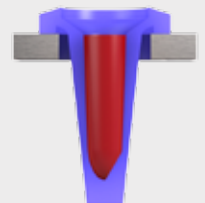

Unmoulding

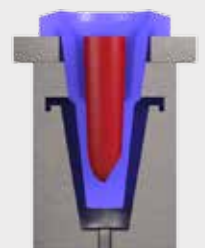

Picking



Releasing



TECHNICAL CHARACTERISTICS

Layout:

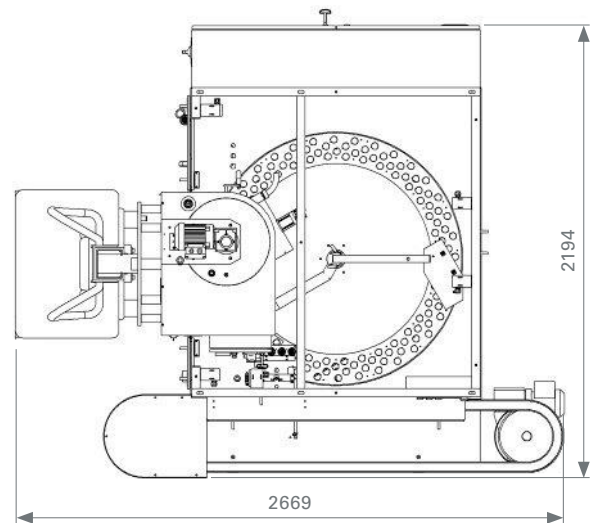
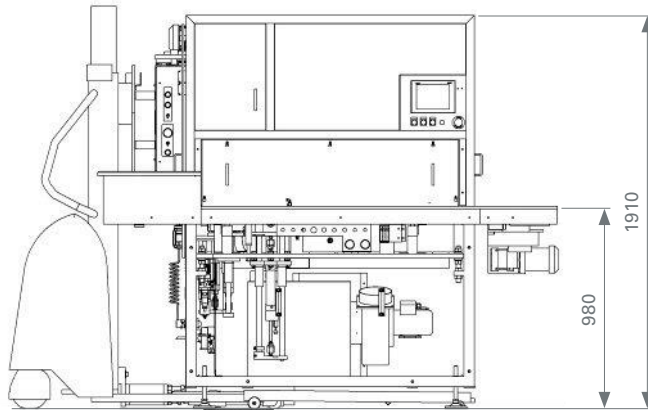

1. Changeover time

- Changeover bulk: 5 minutes for a new colour (without tooling)
- Changeover for a new format: 10 minutes
- No siliconing, no cleaning, no flaming

2. Technical features

- Compatible with all type of mechanisms: Lipstick, pencil, chubby and mini-lipstick
- Large range of filling capabilities including specific forms and logo embossing
- Guards in stainless steel and polycarbonat
- PLC control (colour touch screen)
- Safety: conforms to recommendations APAVE, VERITAS, AIF and CE norms (UL and CSA option)
 - Manual loading on a FlexLink conveyor
 - Mould preheating by by contact
 - Dosing with four plungera with adjustable stroke actuated by servo driver
 - 5 minutes of cooling with cold air
 - Reheating with halogen lamps
 - Opening of the mould for unmoulding
 - Insertion of the bullet into the mechanism with a gripper plate on a manipulator

- Adjustable precision volumetric filling (+/- 1%)
- Speed and volume adjustment from the touchscreen
- BPF - CGMP machine
- Sound level less than 80 dbA at 1 metre
- SIEMENS colour touchscreen
- SIEMENS automatic controller

3. Energy

- Pressure 6 bars
- Electricity 20 kW

4. Lipsticks

- From Ø 8mm to Ø 16 mm
- Length 26 mm to 46 mm

Main options

- Vessels: 10, 20 and 40 litres
- Automatic Lipstick Wind Down Unit
- Orientation device for slim stick formats
- Automatic feeding mechanisms and caps
- Bottom filling
- Protection of the filling of bulk containing silicone
- IQ/OQ documentation

These data are indicative and can be subject to modification without prior notice.

Product range

| Machine | Lipstick filling | | | |
|---|------------------|--------|--------|-------|
| | CRLA10 | CRLA20 | CRLA60 | CL100 |
| Speed in parts per min | 10 | 20 | 60 | 100 |
| Citus Kalix Quality System | ● | ● | ● | ● |
| Changeover time only filling product in min | 5 | 5 | 5 | 5 |
| Changeover time complete format in min | 10 | 10 | 20 | 20 |
| Changeover without tooling | ● | ● | ● | ● |
| Options availability | ● | ● | ● | ● |



coesia

coesia.com

Coesia is a group of innovation-based industrial solutions companies operating globally, headquartered in Bologna, Italy.

Coesia's companies are leaders in the sectors of:

- **Advanced automated machinery and materials**
- **Industrial process solutions**
- **Precision gears**

Coesia's customers are leading players in a broad range of industries, including Consumer Goods, Tobacco, Healthcare, Aerospace, Racing & Automotive and Electronics.



citus-kalix.fr

CITUS KALIX
ZA du Bois de l'Épine
6 avenue du Bois de l'Épine
F-91080 Courcouronnes – France
Tel +33 (0)1 69 87 46 46
Fax +33 (0)1 69 90 75 15
e-mail machines: sales@citus-kalix.fr
e-mail after-sales: support@citus-kalix.fr