

A452F

CARTONING MACHINE FOR CHEESE



FLEXIBLE AND DEPENDABLE

Designed for the cartoning of square and rectangular portions of processed, fresh or cream cheese, the A452F is a highly reliable and flexible solution.

According to customer's requirements, the A452F cartoner can be supplied with various types of infeed sections, depending on the product to be handled and on the requested pack configuration.

The machine uses flat blank cartons which are formed around the product during the loading operation.



TECHNICAL DATA

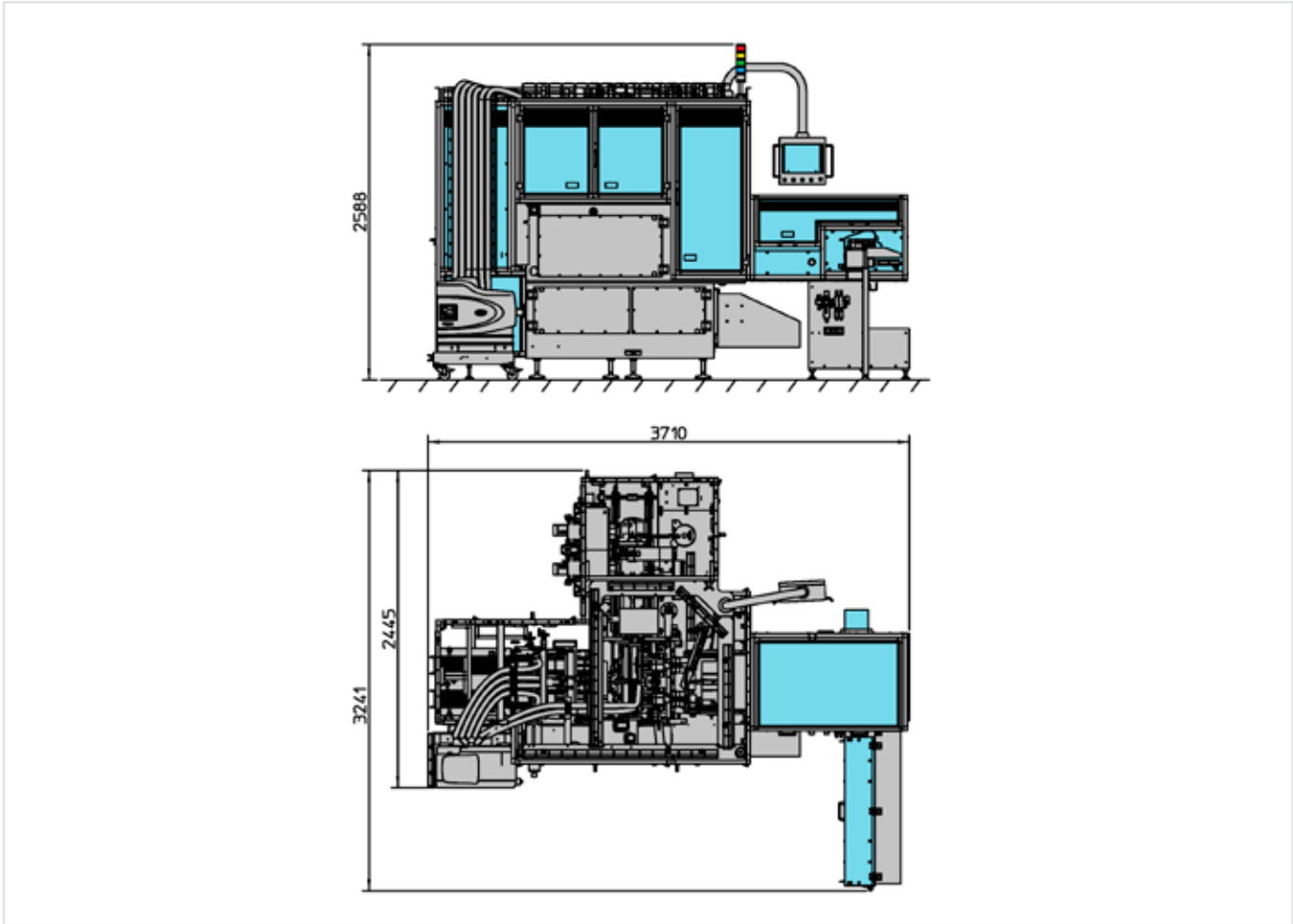

Production capacity	Up to 80 boxes/min
Full load current	3P x 400 Volt – 50 Hz – 8 Amp
Compressed air consumption	350 NI/min. (min. op. pressure 6 bar)
Weight	3,700 Kg Approx.

<p>Box dimensions</p>	A (min ÷ max)
	59 ÷ 150
	B (min ÷ max)
	56 ÷ 75
	C (min ÷ max)
	22 ÷ 62

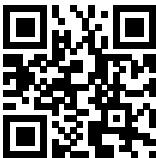

CORAZZA S.p.A.
 Via Natalino Corazza, 9 - 40128 Bologna - Italy
 Tel. +39 051 4192011
dairyfood@ima.it
www.ima.it/foodanddairy

