

Improve your process with the Scott Plow Mixer

The Scott Plow Mixer's innovative design incorporates high-intensity wedge-shaped plows to deliver a fluidized mixing zone. The mixer shaft operates at higher speeds than a traditional batch mixer, and when combined with the cylindrical vessel design, it provides excellent mixing results.



The fluidized bed created by the mixing action offers the product excellent surface area coverage on the mixer cylinder. In addition, this action significantly increases the efficiency of the jacketed unit to act as a drying or cooling vessel.



Clamshell and hinged-door designs are sanitary and allow for complete mixer access. In addition, safety limit switches are provided on all mixer access points.

Plow Mixers are ideal for the following applications:

- Spices and seasoning
- Cellulose
- Iron Oxide
- Pigments
- Masonry cement
- Foundry dust
- Powders
- Bentonite clay
- Calcium carbonate
- Carbon black
- Lime
- Wood flour
- Tobacco
- Resins

Plow Mixers are commonly used in these industries:

- Pet food
- Food/manufacturing
- Plastics/pellets
- Fertilizer
- Chemical
- Minerals
- Pharmaceuticals





Plow Mixer

Innovative solutions for your processing challenges

Scott Equipment Company has developed a versatile plow mixer that various process industries have come to rely on for their mixing requirements. Our plow mixer is durably constructed with a horizontal mixing chamber. Cylindrical in shape, it has a solid shaft with the mixer elements welded or bolted to the support posts. In addition, the plow mixer is available with all of the necessary sanitary features to meet USDA, FDA, or 3A requirements.

Our standard size low Mixers include:

Plow Mixer Dimension Chart									
MODEL NO.	SIZE	CAPACITY CU. FT.	DIA A	DIM B	DIM C	DIM D	DIA E	DIM F	DIM G
PL243	24" X 30"	6	24	36	12	32	22	28	15
PL304	30" X 48"	10	30	48	14	40	26	36	19
PL364	36" X 48"	18	36	48	14	40	30	42	22
PL488	48" X 96"	65	48	96	15	44	36	54	28
PL4810	48" X 120"	82	48	120	15	44	36	54	28
PL5410	54" X 120"	100	54	120	16	50	40	60	31
PL3012	60" X 144"	150	60	144	16	54	44	66	34



Plow Mixer Features:

- Custom manufactured in carbon steel, 304 stainless steel, or 316 stainless steel.
- Full sanitary designs available up to 3A dairy standard
- Optional high-speed choppers aid mixer performance as they de-agglomerate and assist in the distribution of liquids being mixed
- A full clamshell access door allows the top third of the mixer to open for easy cleaning and maintenance
- Versatile design for either batch or continuous process
- Optional high-pressure steam or water jackets for heating or cooling applications

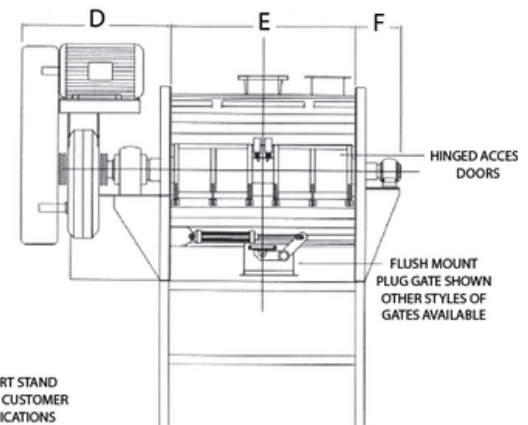
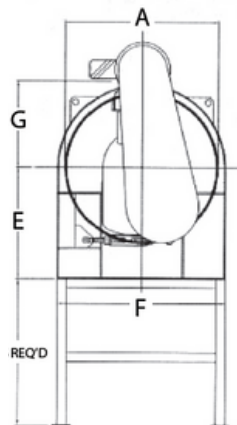

Customize your equipment by contacting us:

